



MOTORTRONICS™

Solid State AC Motor Control

MEDIUM VOLTAGE TRANSFORMERS



C **UL**® US



5kV
CLASS

7kV
CLASS

12kV
CLASS

15kV
CLASS

PATENT 7,737,814

MEDIUM VOLTAGE TRANSFORMERS

INDOOR VOLTAGE TRANSFORMERS



MODEL 3PT3-60 Accuracy Class: 0.3 WX, 0.6M, 1.2Y at 100% rated voltage with 120V base ANSI burden.

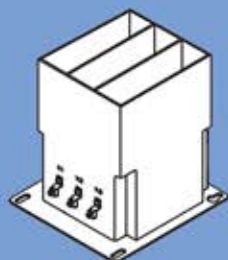

GROUP	CATALOG NO. FUSES	CATALOG NO. FUSE CLIPS ONLY	RATED PRIMARY VOLTAGE	RATIO	SUGGESTED FUSE RATING
1	3PT3-60-841FFF	3PT3-60-841CCC	840	7:1	1.0E
1	3PT3-60-122FFF	3PT3-60-122CCC	1200	10:1	1.0E
1	3PT3-60-242FFF	3PT3-60-242CCC	2400	20:1	0.5E
2	3PT3-60-332FFF	3PT3-60-332CCC	3300	30:1	0.5E
2	3PT3-60-422FFF	3PT3-60-422CCC	4200	35:1	0.5E
2	3PT3-60-482FFF	3PT3-60-482CCC	4800	40:1	0.5E

5kV Class
15kV Class

PTG3-1-60 & PTG3-2-60 Accuracy Class: 0.3 WXY, 0.6M, 1.2Z at 100% rated voltage with 120V based ANSI burden.

Insulation Level: 5.6 kV, 60kV BIL Full Wave 0.3 WX, 0.6M, 1.2Y at 58% rated voltage with 69.3V based ANSI burden.

PATENT

PTW3-1-60 & PTW3-2-60 Accuracy Class: 0.3 WXY, 1.2Z at 100% rated voltage with 120V based ANSI burden.

Insulation Level: 5.6 kV, 60kV BIL Full Wave 0.6 WX, 1.2MY at 58% rated voltage with 69.3V based ANSI burden.

7,737,814

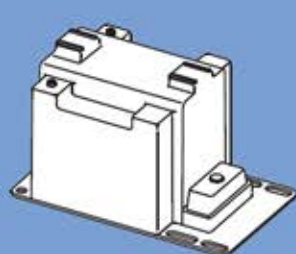

UNFUSED

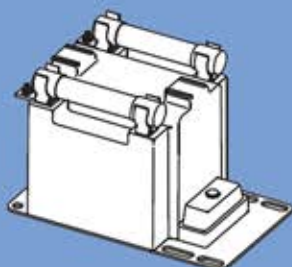

TWO FUSE

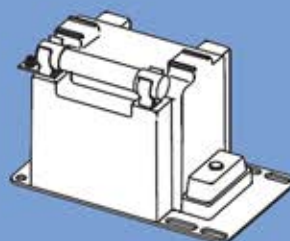

ONE FUSE

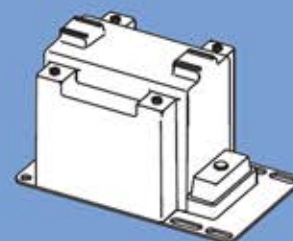

SWITCHGEAR STYLE

GROUP	TWO BUSHING			CATALOG NUMBERS			
	PRIMARY VOLTAGE	RATIO	SECONDARY VOLTAGE	UNFUSED	FUSES	FUSE CLIPS ONLY	SWITCHGEAR STYLE
				PT*3-2-60-242	PT*3-2-60-242FF	PT*3-2-60-242CCS or CCL	PT*3-2-60-242SS
1	2400	20:1	120	PT*3-2-60-242	PT*3-2-60-242FF	PT*3-2-60-242CCS or CCL	PT*3-2-60-242SS
2	3300	30:1	110-50Hz	PT*3-2-60-332	PT*3-2-60-332FF	PT*3-2-60-332CCS or CCL	PT*3-2-60-332SS
2	4200	35:1	120	PT*3-2-60-442	PT*3-2-60-442FF	PT*3-2-60-442CCS or CCL	PT*3-2-60-442SS
2	4800	40:1	120	PT*3-2-60-482	PT*3-2-60-482FF	PT*3-2-60-482CCS or CCL	PT*3-2-60-482SS

GROUP	ONE BUSHING			R _{TH}	CATALOG NUMBERS		
	PRIMARY VOLTAGE	RATIO	SECONDARY VOLTAGE		FUSES	FUSE CLIPS ONLY	SWITCHGEAR STYLE
					PT*3-1-60-242F	PT*3-1-60-242CS or CL	PT*3-1-60-242S
4A	2400	20:1	120	230	PT*3-1-60-242F <td>PT*3-1-60-242CS or CL <td>PT*3-1-60-242S</td> </td>	PT*3-1-60-242CS or CL <td>PT*3-1-60-242S</td>	PT*3-1-60-242S
4B	4200	35:1	120	230	PT*3-1-60-332F <td>PT*3-1-60-332CS or CL <td>PT*3-1-60-332S</td> </td>	PT*3-1-60-332CS or CL <td>PT*3-1-60-332S</td>	PT*3-1-60-332S
4B	4800	40:1	120	230	PT*3-1-60-442F <td>PT*3-1-60-442CS or CL <td>PT*3-1-60-442S</td> </td>	PT*3-1-60-442CS or CL <td>PT*3-1-60-442S</td>	PT*3-1-60-442S

Substitute * with 'G' or 'W' for correct catalog number.

MEDIUM VOLTAGE CONTROL POWER TRANSFORMERS

7.2kV Class

MODEL CPT3-60-2

Insulation Level: 6.9 kV, 60kV BIL Full Wave

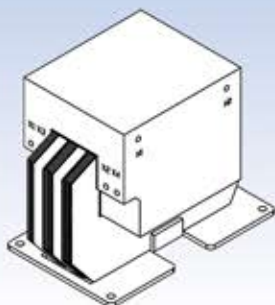

CATALOG NO	PRIMARY VOLTAGE	RATIO AT 110V "-5"	RATIO AT 120V "-6"	SECONDARY VOLTAGE "-5" Model	SECONDARY VOLTAGE "-6" Model	FREQUENCY Hz	THERMAL RATING
CPT3 60 2 2400 - *	2400	21.81	20.00	110/220	120/240	50/60	2.0 kVA
CPT3 60 2 3300 - *	3300	30.00	27.50	110/220	120/240	50/60	2.0 kVA
CPT3 60 2 4160 - *	4160	37.81	34.66	110/220	120/240	50/60	2.0 kVA
CPT3 60 2 4800 - *	4800	43.63	40.00	110/220	120/240	50/60	2.0 kVA
CPT3 60 2 5000 - *	5000	45.45	41.66	110/220	120/240	50/60	2.0 kVA
CPT3 60 2 5500 - *	5500	50.00	45.83	110/220	120/240	50/60	2.0 kVA
CPT3 60 2 6000 - *	6000	54.54	50.00	110/220	120/240	50/60	2.0 kVA
CPT3 60 2 6600 - *	6600	60.00	55.00	110/220	120/240	50/60	2.0 kVA
CPT3 60 2 6900 - *	6900	62.72	57.50	110/220	120/240	50/60	2.0 kVA

Substitute * with '5' 110/120V or '6' 120/240V for correct catalog number.

Motortronics / Phasetronics

1600 Sunshine Drive

Tel: 727.573.1819 or 888.767.7792

E-mail: sales@motortronics.com

Clearwater, Florida 33765

Fax: 727.573.1803 or 800.548.4104

www.motortronics.com

PN: VT-MV071514